

2-1/4" DTU OAL

1/2" TRIM

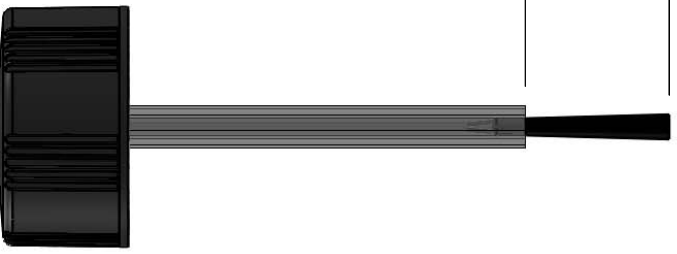

2-1/4" OAL DTU BRUSH
NNS, NYLON FILL, STAINLESS STEEL
TYPE 302 .018" STAPLE
DT00111

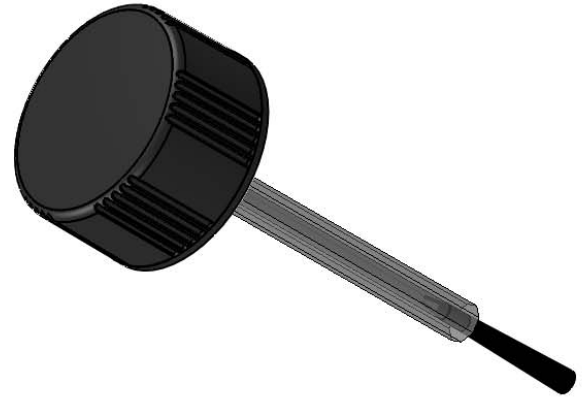

.040" P/E LINER

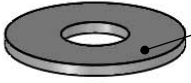

RS18/400-C
BLACK PHENOLIC
ITEM#47518

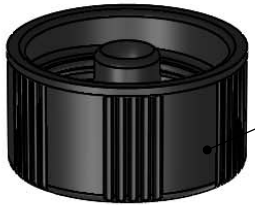

UNLESS OTHERWISE SPECIFIED:

DIMENSIONS ARE IN INCHES
TOLERANCES:
FRACTIONAL ±1/16"
ANGULAR ±2°
TWO PLACE DECIMAL ±.02
THREE PLACE DECIMAL ±.010

| | NAME | DATE |
|---------|------|---------|
| DRAWN | SWC | 6/8/17 |
| CHECKED | JME | 6/12/17 |
| | | |
| | | |



TITLE:
18/400 RS BLK C 2-1/4"
OAL DTU NNS .040 P/E

| CUSTOMER APPROVAL: | |
|--------------------|------|
| NAME | DATE |
| | |

| NO. | REVISION | NAME | DATE |
|-----|------------------|------|----------|
| 00 | ORIGINAL DRAWING | SWC | 6/8/2017 |
| | | | |
| | | | |
| | | | |
| | | | |

PROPRIETARY AND CONFIDENTIAL

THE INFORMATION CONTAINED IN THIS DRAWING IS THE SOLE PROPERTY OF NATIONAL NOVELTY BRUSH CO. ANY REPRODUCTION IN PART OR AS A WHOLE WITHOUT THE WRITTEN PERMISSION OF NATIONAL NOVELTY BRUSH CO. IS PROHIBITED.

SCALE: 3:2
DO NOT SCALE DRAWING

SHEET 1 OF 1

| SIZE | DWG. NO. | REV |
|------|------------|-----|
| A | ITEM #3140 | 00 |